

# 6020-2RS1 Deep groove ball bearings

- Popular item  
- SKF Explorer

## Deep groove ball bearings

### Bearing data

[Tolerances](#),

Normal (metric), P6, P5, Normal (inch),

[Radial internal clearance](#),

Matched bearing pairs, Stainless steel  
 $d < 10$  mm, Other bearings

### Bearing interfaces

[Seat tolerances for standard conditions](#),

[Tolerances and resultant fits](#)

## Technical specification

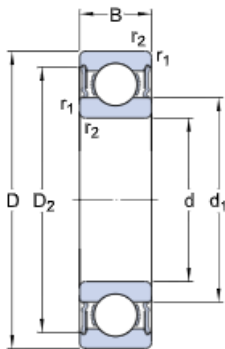

### DIMENSIONS

d	100 mm	Bore diameter
D	150 mm	Outside diameter
B	24 mm	Width
$d_1$	≈ 115.95 mm	Shoulder diameter
$D_2$	≈ 138.3 mm	Recess diameter
$r_{1,2}$	min. 1.5 mm	Chamfer dimension

### ABUTMENT DIMENSIONS

$d_{\xi}$ min.	107 mm	Diameter of shaft abutment
$d_{\xi}$ max.	115.9 mm	Diameter of shaft abutment
$D_{\xi}$ max.	143 mm	Diameter of housing abutment
$r_a$ max.	1.5 mm	Radius of shaft or housing fillet

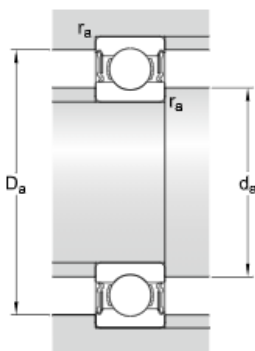

## CALCULATION DATA

C	63.7 kN	Basic dynamic load rating
C <sub>0</sub>	54 kN	Basic static load rating
P <sub>u</sub>	2.04 kN	Fatigue load limit
	2 600 r/min	Limiting speed
k <sub>r</sub>	0.025	Minimum load factor
f <sub>0</sub>	15.9	Calculation factor

## MASS

	1.3 kg	Mass bearing
--	--------	--------------

## TOLERANCE CLASS

P6	Dimensional tolerances
Normal	Radial run-out